

One Type Analog Display coupled with Multi-Digital Display.

# DUAL GAUGE

# USER'S MANUAL

## Easy Installation

WATER TEMP+DIGITAL

# DXW

Designed for Subaru BRZ and Toyota 86 Models

Thank you for purchasing this PIVOT product.  
Please read this manual carefully and keep it for future reference.

● If this product is given to another user, make sure to include this User's Manual.

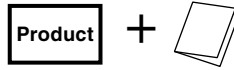

## Contents

Contents / WARNING / CAUTION ..... 1  
 Features ..... 1  
 Part Names and Displays ..... 1  
 Wiring Method and Installation ..... 2  
   Installing with Insert Holder ..... 2~3  
   Installing without Insert Holder ..... 3  
 Basic Operation ..... 4  
 Switching The Display ..... 4  
 Illumination brightness settings ..... 4  
 Troubleshooting ..... 4

## Please check the contents of the package

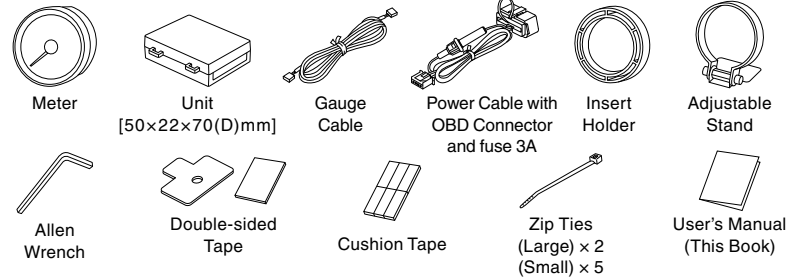

- The display will not be proper if the ECU being used is not the standard one or if a sub-computer is being used, even in compatible car models.
- Cannot be used in combination with other company's products that use Diagnostic Monitoring Connectors.

### **WARNING** Improper use or disregard of these warnings may result in the injury or death of people.

- **Do not work in areas where there is excessive exhaust.**  
Due to vehicle exhaust emission poisoning or fire may result in a damage to humans.
- **Do not crush the cable.**  
Please be careful that the cable does not get crushed by the seat rail or car door steel plate, nor cut by any sharp steel plate as this may cause a poor connection or an electric short leading to fire or other danger.
- **Do not operate while driving.**  
Operating or checking the display during driving may cause an accident; please use with the utmost consideration for safety.
- **Please securely fasten the product to a stable place and be sure to store bundle away all wires with tape, etc...**  
It is very dangerous to pull tangled wires by force or allow tangled wires to interfere with driving.

### **CAUTION** Improper use or disregard of these warnings may cause injury to persons, damage the product and other things.

- **This product is for DC12V cars;**  
Installation cannot be carried out on cars with other voltage batteries.
- **Just after installation do not exert any strong force on the product.**  
When double-sided tape is used for an installation be warned that when hot the tape temporarily loses adhesiveness.
- **Do Not Use Chemical Cleaners.**  
If the unit gets dirty please wipe with a soft cloth to remove any dirt. Do not use chemical cleaners such as thinner, benzene, or alcohol.
- **Do not install the product in any place subject to high temperature or any place where water may be splashed.**
- **Make sure to replace all screws and parts to their original place.**
- **Do not install the product in a place where it will cause distraction.**
- **Do not, in any manner, process, take apart, or make changes to this product.**

## Features

DXW, which operates by simply connecting to the diagnostic monitor connector, designed exclusively for use with Subaru BRZ and Toyota 86. Two types of holders to choose from: a band holder for dashboard installation and a specialized holder for installation to the air conditioner vent that keeps the breeze coming.

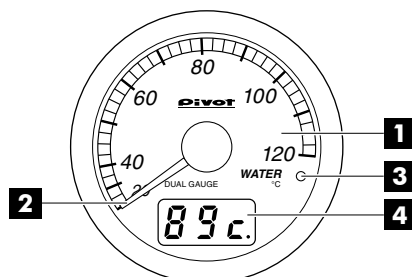

## Part Names and Displays

- 1 Analog Display** Display Water Temp data.
- 2 Needle** Shows the current values and peak value.
- 3 Switch** Use to change modes of digital display and reset the peak value.
- 4 Digital Display** Display switches between types.
- 5 Illumination (night illumination)** Normally illuminated when on display and Two-step dimming.

Analog Display	Dial : White, Needle : Red (DXW-W)
	Dial : Red, Needle : Red (DXW-R)
Digital Display	Red
Analog Display	Water Temp [20 ~ 120 °C]
Digital Display	Oil Temp / Intake Temp [-35 ~ 150 °C]

# Wiring Method and Installation

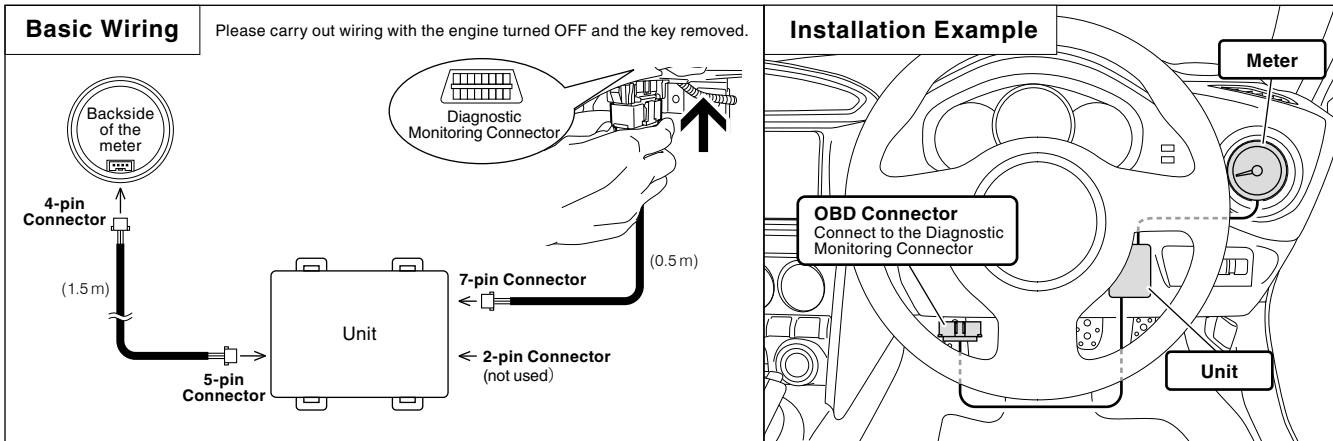

## Installing the product with Insert Holder

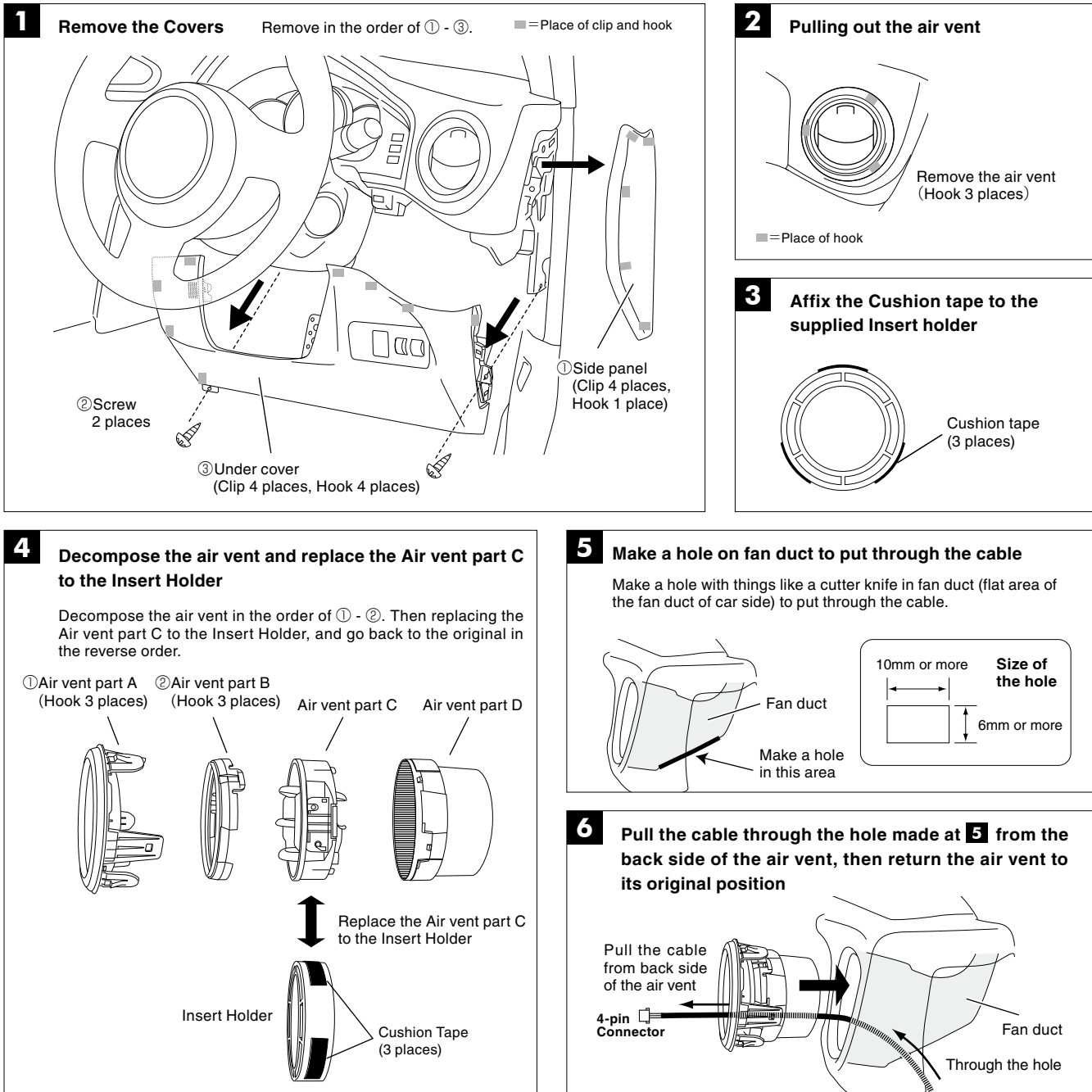

- 7** Affix Cushion tape to the base of the meter and connect the 4-pin connector through out the air vent at **6**. Then press into the Insert Holder combined with the air vent.

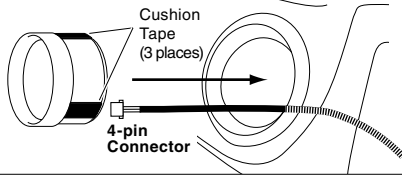

- 8** Connect 5-pin connector and 7-pin connector(power cable) , then fasten the unit.  
⇒See ※1 [Installing The Unit] below.

- 9** Connect the power cable to the Diagnostic Monitoring Connector, and bind the extra cables.

- 10** Return the panels to its original place by going in the reverse order from **1** .

**※1 Installing The Unit**

As shown in the right diagram , fasten the unit into positions not usually affected by water.

(Example of Installation)

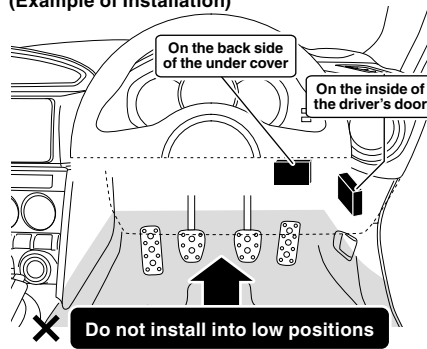

**Fastening to Flat Space**

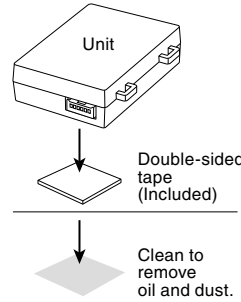

**When Fastenings to a Cable or Pipe**

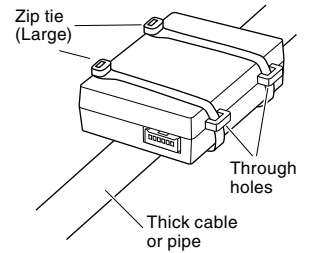

**Installing the product without Insert Holder**

- Decide a install location of the meter and connect the 4-pin connector, then fasten the meter.
- Connect 5-pin connector and 7-pin connector(power cable) , then fasten the unit. ⇒See ※1 [Installing The Unit] above.
- Connect the power cable to the Diagnostic Monitoring Connector, and bind the extra cables.

**Installation the Meter**

**Installation with the Adjustable Stand included**

Fasten using the double-sided tape. (On top of the steering column cover or dashboard.)

- ① Slightly loosen the Hexagonal bolt and install the gauge into the Adjustable Stand.

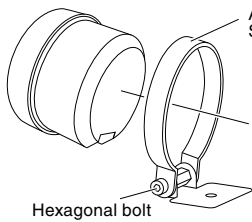

- ② Fasten using the double-sided tape. (Clean the surface; removing all oil and dust.)

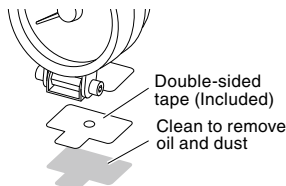

\*Please be sure about where you wish to install the meter, as it is not advisable to reuse double-sided tape.

- ③ After deciding the position and angle of the meter face, fasten the Hexagonal bolt on both sides to secure.

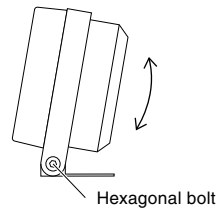

\*It is possible to install the Adjustable Stand in the reverse direction.

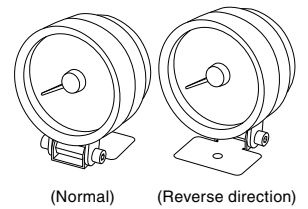

**Mount into the Panel**

- ① Put the cushion tape to the base of the meter.  
② Press into the 60 mm hole in the panel.

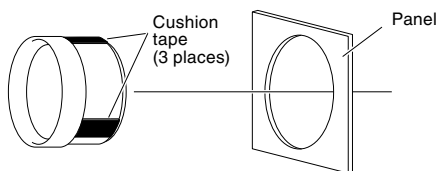

**Meter Dimensions (unit; mm)**

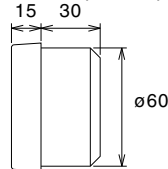

\*If you wish to fasten the unit to the A-pillar or column cover, please purchase and use the separately sold meter holder which gives you installation a clean natural look. (For mounting to the A-pillar or other slanted surface, it is necessary to use screws.)

- Meter Hood 60 (for ø60)**  
**MH6-U (Multi-Purpose Type)** ¥2,980  
**MH6-C (Processing Kit)** ¥2,980

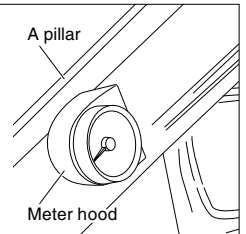

**[Reference] Notes about using the OBD Connector**

Make sure to grip the distended portions when pulling it out or inserting it.

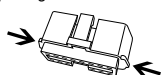

**CAUTION**

Do not pull on the wires when trying to remove the connector; the wires may become disconnected.

**If you unable to get a grip on the distended portions.**

With some car models it may be difficult to get a good grip on the connector.

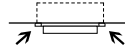

In such case, pull out the connector by pulling on the end of the zip tie.

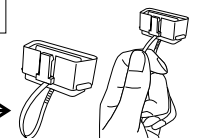

**! About Using OBD Products in Combination**

If you wish to use DUAL GAUGE in combination with products in our 3-drive Series (FLAT or COMPACT), PROGAUGE the "OBD2 Wiring Kit OBD-EH" (sold separately ¥3,200) makes installation a snap.

For more details about using combinations of products see here. ⇒ <http://pivotjp.com/obd-e/>

\*When using the DUAL GAUGE with products mentioned above, they can only be used together in compatible model vehicles for both products.

# Basic Operation

- 1 Key Switch ON (Engine start)**
- 2 Opening Demo**
- 3 Display Each Mode**
- 4 Key Switch OFF (Engine stop)**
- 5 Meter OFF**  
The needle stops in the vicinity of lowest value.

## Opening Demo

- When the key is turned ON the needle will move to the extreme left several times for searching position. Then it will move to the maximum value and finally to reading for current measurement item.
- Due to analyzation time for the car data transmission it may take up to a few seconds from engine start before opening demo.

# Switching The Display

## Switching The Digital Display

Press switch to change the multi-digital display in operation

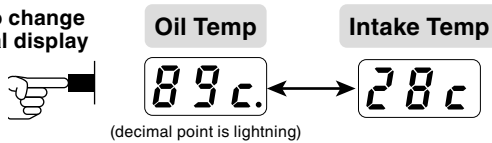

## Oil Temp / Intake Temp Reading the Display

[ -35 ~ -1 °C ] The first place on the below shows "-" (minus).	[ 0 ~ 99 °C ] The third place from the below shows "C" (Celsius).	[ 100 ~ 150 °C ] Numerical Value Only.
- 00	00 C	100

## Display and Reset the Peak Value

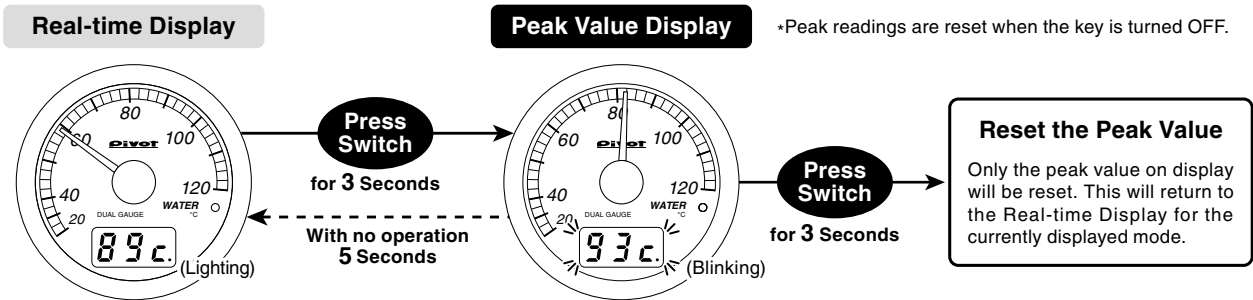

# Illumination brightness settings

Adjustment in case of anxious about reflected illumination of door mirror or something

- 1** Press the switch for 6 seconds  
Holding downs the switch in operation
- 2** Display a peak value after 3 seconds and the current brightness after 6 seconds  
 (Initial value)  
 Release the switch after displayed the current setting
- 3** Press the switch Each pressing will change the brightness
- 4** Release the switch after setting is done
- 5** Back to normal display with no operation for 3 seconds **Setting Completed**

# Troubleshooting

Trouble	Possible Causes	Possible Solutions
Does not work with Engine start.	Poor connection of <b>Gauge cable</b> , <b>7-pin Connector</b> or <b>OBD Connector</b> wires. The unit has been installed into an incompatible car model.	Please reconfirm whether wiring and connections are correct or not.
Upon starting up, the unit will not start in the newly changed display.	Because after changing displays, if the car's engine is turned off within 3 seconds, the new setting will not be stored, make sure to wait at least 3 seconds before turning the engine off.	
Before the opening demo starts the needle briefly moves.	This is due to a special characteristic of the meter and is not a malfunction.	
The displayed values are different from the standard meter.	Due to the ECU information received, the displayed values on this product may differ from those of standard or other meters.	

※Our products have already been recognized as our Industrial Property or are in the process of receiving Industrial Property status.  
 ※We plan in the near future to take all possible legal measures to protect against unfair competition from look-alike products using similar designs, regulating characteristics, circuitry and circuitry layout.  
 ※We strictly prohibit the unlicensed use of the PIVOT trademark and the unauthorized use of PIVOT User's Manual.