

# USER'S MANUAL

Thank you for purchasing this PIVOT product. Please read this manual carefully before installation and use. Please keep this manual for future reference.

**ISC IDLING STOP CANCELLER**

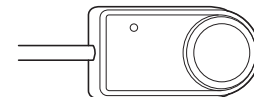

For CR-Z (Manual Trans.)

If this product is given to another user, make sure to include this User's Manual.



## Contents

Contents / CAUTION / NOTE ..... 1  
 Function / Features ..... 2  
 Part Names ..... 2  
 Connecting The Wires ..... 2~3  
 Fastening The Product ..... 3  
 How To Operate ..... 4  
 Troubleshooting ..... 4

## Please check the contents of the package

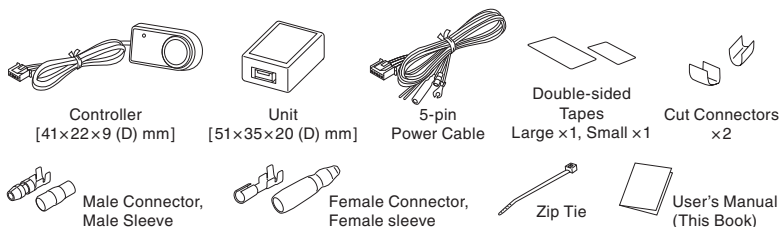

**In the following circumstances the unit cannot be installed; doing so may cause damage.**

- The ECU is different from the standard for that model
- If a sub-computer is being used.

### **WARNING**

Improper use or disregard of these warnings may result in the injury or death of people.

- Do not work in areas where there is excessive exhaust.**  
Due to vehicle exhaust emission poisoning or fire may result in a damage to humans.
- Please securely fasten the product to a stable place.**  
It is very dangerous if, while in use, the product falls off and interferes with braking.
- Do not crush the cable.**  
Please be careful that the cable does not get crushed by the seat rail or car door steel plate, nor cut by any sharp steel plate as this may cause a poor connection or an electric short leading to fire or other danger.
- Do not operate while driving.**  
Operating or checking the display during driving may cause an accident; please use with the utmost consideration for safety.
- Please be sure to store bundle away all wires with tape, etc...**  
It is very dangerous to pull tangled wires by force or allow tangled wires to interfere with driving.

### **CAUTION**

Improper use or disregard of these warnings may cause injury to persons, damage the product and/or other things.

- Just after installation do not exert any strong force on the product.**  
When double-sided tape is used for an installation be warned that when hot the tape temporarily loses adhesiveness.
- Do Not Use Chemical Cleansers.**  
If the unit gets dirty please wipe with a soft cloth to remove any dirt. Do not use chemical cleansers such as thinner, benzene, or alcohol.
- Do not install the product in any place subject to high temperature or any place where water may be splashed.**
- Make sure to replace all screws and parts to their original place.**
- Do not install the product in a place where it will cause distraction.**
- Do not, in any manner, process, take apart, or make changes to this product.**
- Do not use electrotap.**

# Functions and Features

The ISC allows the user to switch on and off the idling stop mechanism in CR-Z cars in the same manner as other cars (Vitz, March, Wagon R, Axela and others).

- Slow Response at Take-off** Prevents slow take-off when restarting
- Air Conditioner Performance** Prevents loss of humidity and cooling deficiency when compressor stops
- Restart Discomfort** Prevents discomforting vibration upon restart
- Control without causing error codes** Independent control system means no errors such as "IMA System Error"

# Part Names

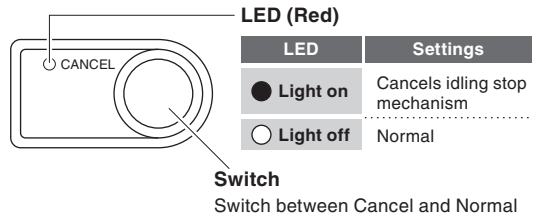

## About the LED Lamp

\*This product is interlocked with the ECU (engine computer) power. Because of this, it may take up to 5 minutes for the LED to go off after turning off the engine; it is not a malfunction. (Only when the idling stop mechanism has been set to be canceled)

# Connecting The Wires

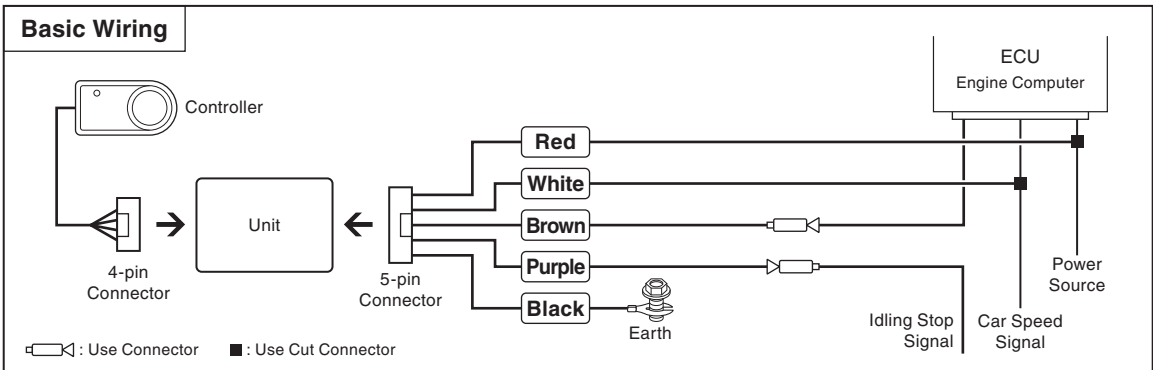

## 1 Connect the power, speed signal and idling stop signal.

\*The ECU is located in the engine room at the rear of the battery.

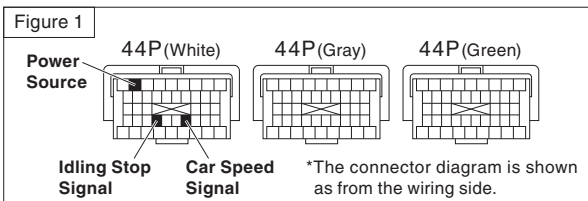

- Remove the battery cables from the minus terminals.
- Using one of the supplied cut connectors, connect the **Red** wire to the power position as shown in Figure 1.
- Using the same procedure as in ②, connect the **White** wire to the car speed signal position.
- Cut the idling stop signal wiring as shown in Figure 1.
- Using one of the supplied connectors, connect the **Purple** wire and the **Brown** wire. (See Figure 2)

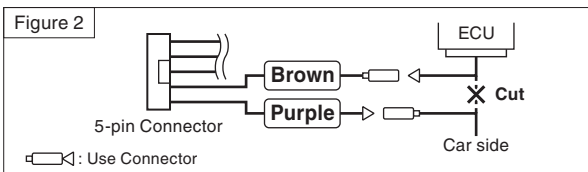

## 2 Connect the Earth.

- Near the hood arm, fasten down the spade terminal of the **Black** wire to the earthing point.

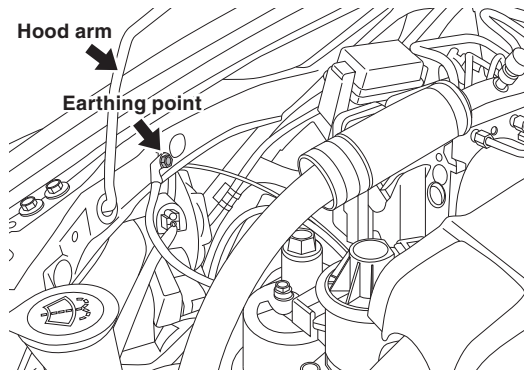

### 3 Pull the cable to the inside of the car.

- ① Remove the right front inner fender.
- ② As shown in the figure below, pull the 5-pin connector from the grommet into the inside of the car.

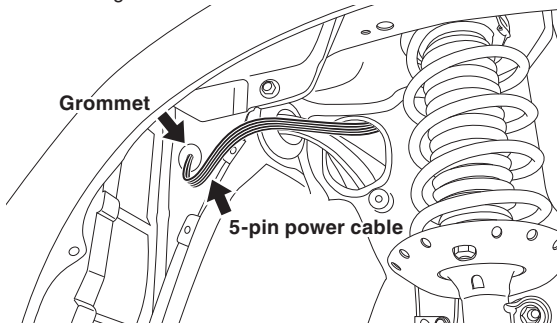

- ③ After fastening down the 5-pin power cable and the seal of the grommet, replace the inner fender.  
\*For waterproofing, place a seal around the grommet. Also, to prevent tucking, fasten down the 5-pin power cable.

### 4 Connect Each Connector to the Unit.

- ① Connect both the 4-pin connector from the controller and the 5-pin power connector pulled from the engine room to the appropriate slot on the unit.

## Fastening The Product

 **Please be sure to bundle away all wires with tape, etc...**

While in use if wires become free they may interfere with driving and cause accidents. Also, wires which are smashed or crushed may result in a short and can be extremely dangerous.

- **Installing The Unit** As shown in the diagram below, fasten the unit into positions not usually affected by water.  
(Example of Installation)

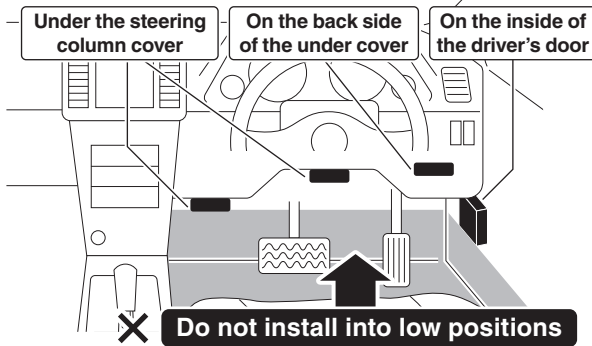

#### (How to Install)

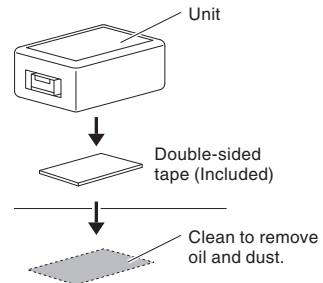

- **Installing The Controller** Affix with double-sided tape to a position which is easy to see and which allows for easy operation.  
(Example of Installation)

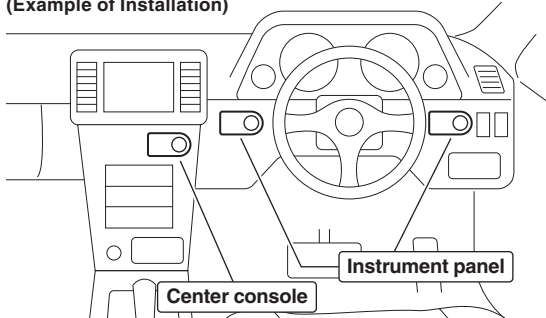

#### (How to Install)

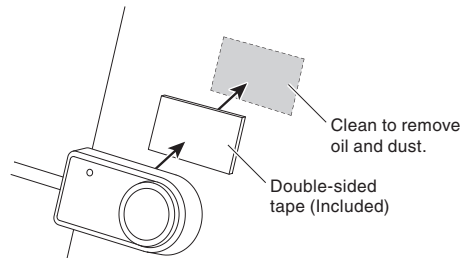

- ① Using the supplied double-sided tape, fasten down both the unit and the controller.
- ② So as not to obstruct driving make sure to bundle all loose wires and cables.
- ③ Make sure to replace everything that was removed or disconnected during installation and reconnect the battery's minus terminal.

**[Reference 1] How to use the Male Connectors**

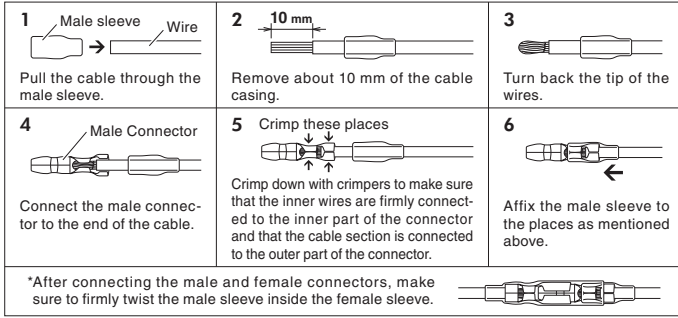

**[Reference 2] How to use the Cut Connectors**

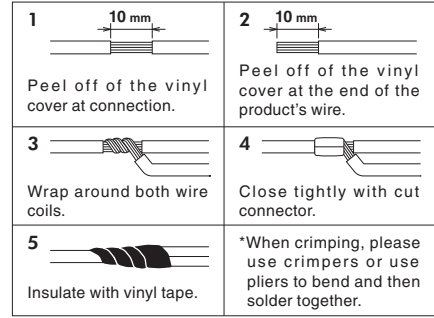

# How to Operate

After having completed Steps **2** to **4** below the settings will be activated.

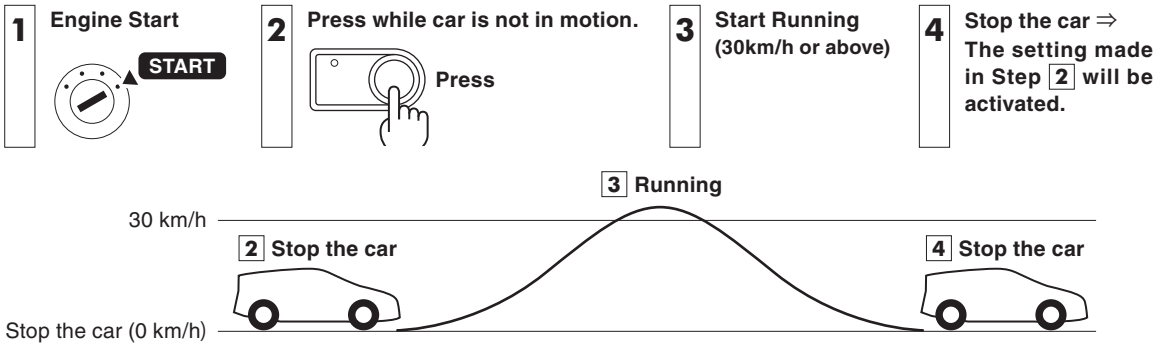

LED	Settings
<input checked="" type="radio"/> Light up	Cancels idling stop mechanism
<input type="radio"/> Light off	Normal

**!** When in "normal", the conditions necessary for the idling stop mechanism to be activated will be the same as for that car model's conditions.

# Troubleshooting

Trouble	Possible Causes	Possible Solutions
I press the switch but the LED does not come on.	Poor connection of <b>Red</b> wire or <b>Black</b> wire.	Please reconfirm whether wiring and connections are correct or not.
Even though the setting has been made to cancel the idling stop mechanism, idling stop still occurs.	Poor connection of <b>White</b> wire.	Please reconfirm whether wiring and connections are correct or not.
	Poor connection of <b>Purple</b> wire or <b>Brown</b> wire.	
	A speed of 30 km/h or more was not reached. Switch operation was carried out while the car was in motion.	Completely stop the car and check the operation again after having made sure that a speed of at least 30 km/h was achieved.
Even though the setting is at "Normal"(idling stop has not been cancelled), the idling stop mechanism does not work.	The necessary conditions for the idling stop mechanism to become activated have not been met.	Check the User's Manual for your car model and read the conditions necessary for Idling Stop.
	A speed of 30 km/h or more was not reached. Switch operation was carried out while the car was in motion.	Completely stop the car and check the operation again after having made sure that a speed of at least 30 km/h was achieved.

\*Our products have already been recognized as our Industrial Property or are in the process of receiving Industrial Property status.  
 \*We plan in the near future to take all possible legal measures to protect against unfair competition from look-alike products using similar designs, regulating characteristics, circuitry and circuitry layout.  
 \*We strictly prohibit the unlicensed use of the PIVOT trademark and the unauthorized use of PIVOT User's Manual.